



Property and Land Records Data

Comprehensive GIS Solutions for Johnson County

Pricing

A detailed fee schedule can be found on the AIMS website at <http://aims.jocogov.org/AIMSData/DataPrices.aspx>

Contact an AIMS representative for current data licensee information.

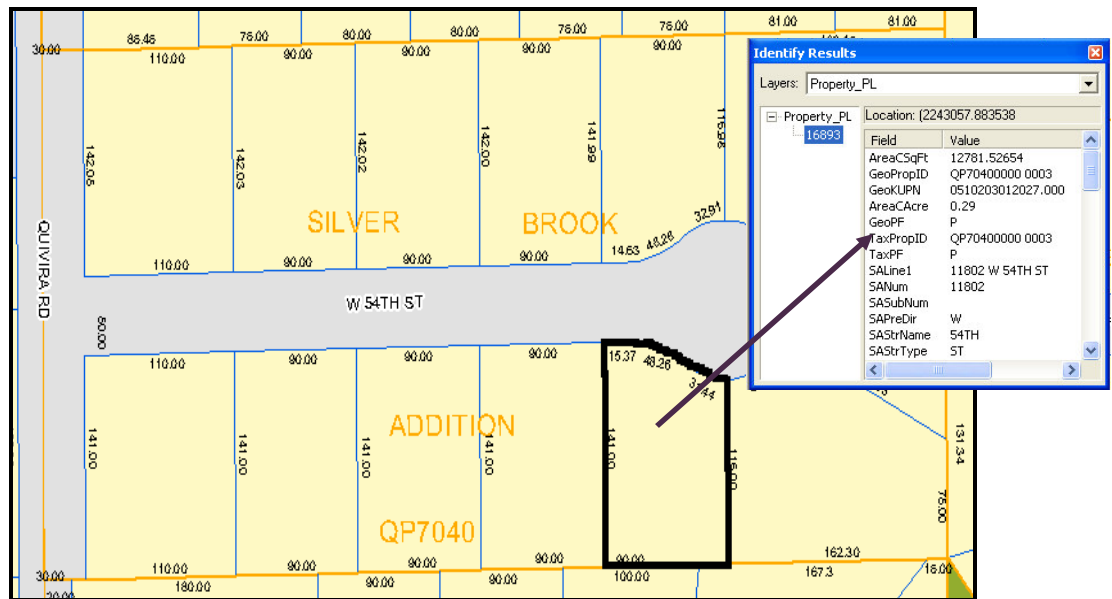

Property and Land Records Data

AIMS maintains an extensive geographic database of property data in Johnson County. Data licensees can purchase the data for use in their business practices.

Property data is not only used to represent geographic features, it can also be used to query and analyze the data that is contained with the property database. This data is better known as land record data. Land record data contains data about a property such as address, owner name, age of the improvements, property number, land value and the calculated area of the property.

Property data can be delivered by AIMS both digitally and in hardcopy format. The property data can also be viewed on the AIMS on-line mapping application at <http://ims.jocogov.org/ims>

Property and Land Record data contain features such as:

- ▶ **Property Boundaries and Dimensions**
- ▶ **Property ID Numbers**
- ▶ **Owner Names**
- ▶ **Addresses**
- ▶ **Land Values**
- ▶ **Year Built**
- ▶ **Area of Land**
- ▶ **Subdivision Boundaries and Names**
- ▶ **Picture of Improvements**